

HDM's VTP10-24 DC voltage transient protector is the solution for voltage transient and surge in the 24V<sub>DC</sub> electrical systems. VTP10-24's advance surge protection circuit absorbs the momentary voltage spikes and prevents damage to electrical equipment. Compact and economical, the VTP10-24 module will ensure uninterrupted system operation and prolong service life of the electrical equipment.

## Technical Specifications

Electrical	
Input Nominal Voltage	28V <sub>DC</sub>
Input Voltage Range	18 ~ 33V <sub>DC</sub>
Input Low Voltage Protection	< 17V <sub>DC</sub>
Input Overvoltage Protection	> 36V <sub>DC</sub>
Maximum Operating Current	10A <sub>DC</sub>
Current Limiting	11A <sub>DC</sub>
Over Temperature Protection	> 105°C
OTP Recovery	10°C Hysteresis
Inline Fuse Rating	ATC 20A
Reverse Polarity Protection	External Fuse
General	
Operating Temperature	-40 ~ +65°C
Storage Temperature	-40 ~ +85°C
Weight	0.4 lb
Dimensions (LxWxH*)	3.11 x 2.0 x 1.32"
Connection	DC In 8" 16 AWG with Inline Fuse DC Out 12" 16 AWG Red Ground 12" 16 AWG Black
Mounting Method	Flange
Warranty	1 year



### Standard Features

- ◆ Optimized for 24V<sub>DC</sub> Systems
- ◆ Low Voltage Protection
- ◆ Overvoltage Protection
- ◆ Reverse Polarity Protection
- ◆ Over Temperature Protection
- ◆ Meets MIL-STD-1275D
- ◆ Meets IP65 Requirement
- ◆ Corrosion-Proof Hardware
- ◆ Flange Mount Configuration

Specifications typical at 25°C unless otherwise stated and are subject to change without notice.

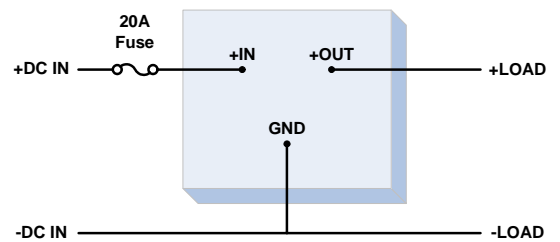
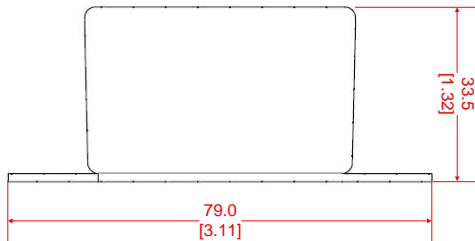
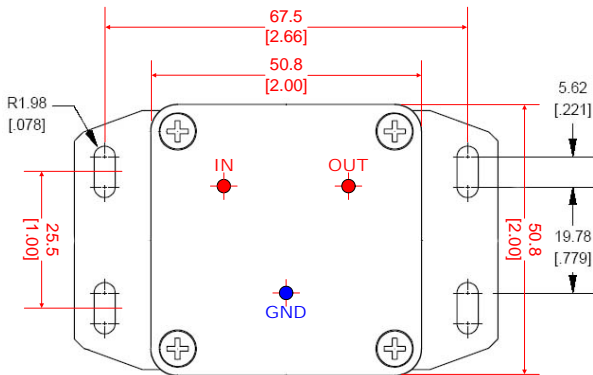

Connection Diagram for VTP10-24

Model	Description
VTP10-24	24V <sub>DC</sub> / 10A <sub>DC</sub> Voltage Transient Protector

Dimensions in millimeters [inches] unless otherwise specified.